

# KRUPS

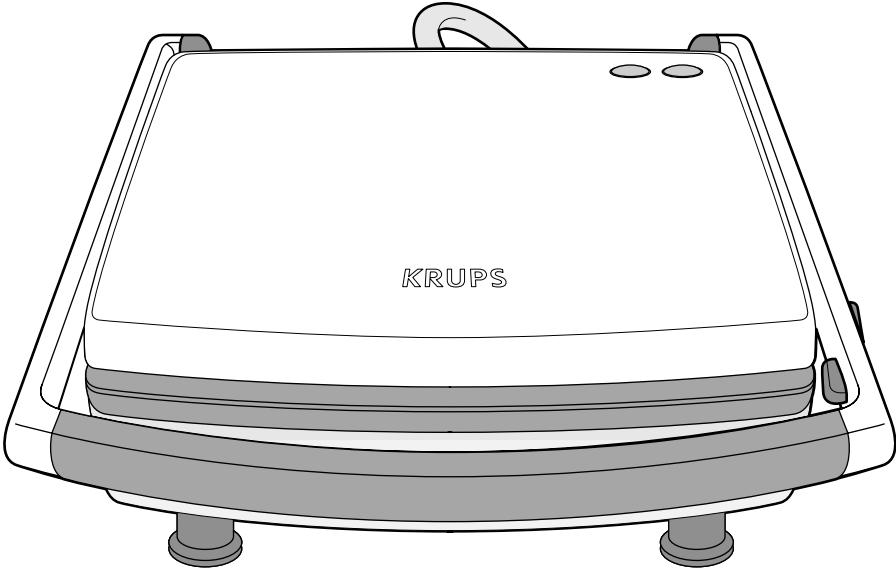

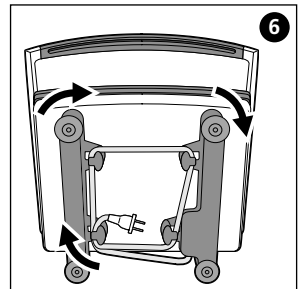
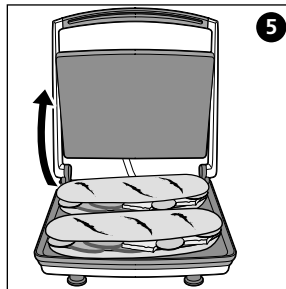
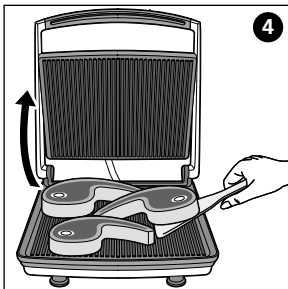
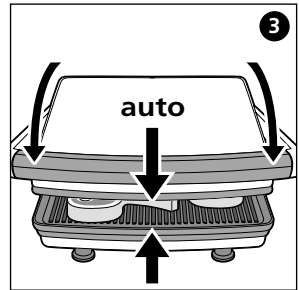
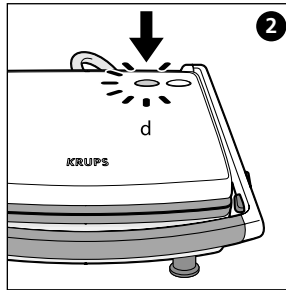
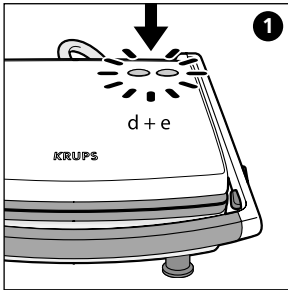
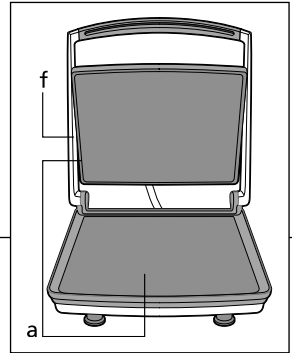
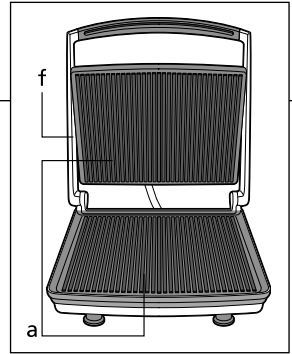
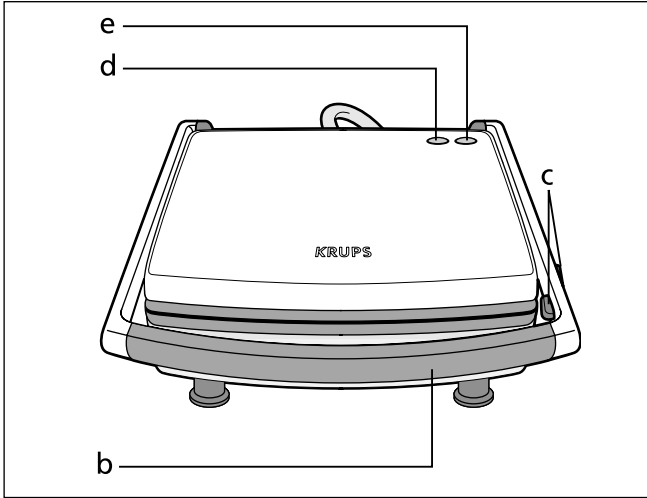

# IMPORTANT SAFEGUARDS

When using electrical appliances, basic safety precautions should always be followed including the following :

- Read all instructions.
- Do not touch hot surfaces. Use handles or knobs.
- To protect against electrical shock, do not immerse cord, plug, or complete appliance in water or other liquids.
- Close supervision is necessary when any appliance is used by or near children.
- Unplug from outlet when not in use and before cleaning. Allow to cool before putting on or taking off parts.
- Do not operate any appliance with a damaged cord or plug or after the appliance malfunctions, or has been damaged in any manner. Return appliance to the nearest authorized KRUPS Service Center for examination, repair or adjustment.
- The use of accessory attachments not recommended or sold by KRUPS may cause injuries.
- Do not use outdoors.
- Do not let the cord hang over the edge of the table or counter, or touch hot surfaces.
- Do not place on or near a hot gas or electric burner or in a heated oven.
- Extreme caution must be used when moving an appliance containing hot oil or other hot liquids.
- To disconnect remove plug from wall outlet.
- Do not use the appliance for other than intended household use.
- Do not use metallic fasteners to hold the food in place. Sharp utensils should not be used.
- Always check that the voltage indicated on the identification panel matches that of your electrical installation.
- For household use only. Using the appliance for other than its intended use will void the warranty.
- Position the appliance on a flat, heat resistant surface.
- Do not leave or use the appliance in a damp area.
- Do not touch the non-stick plates when in use.
- When the appliance is on, do not leave it unattended.
- A fire may occur if the appliance is covered with flammable material including curtains, draperies, walls, etc, when in operation.

# SAVE THESE INSTRUCTIONS

## CAUTION

This appliance is for household use. Any servicing other than cleaning and user maintenance should be performed by the nearest authorized KRUPS Service Center. Visit our website at [www.krups.com](http://www.krups.com) or contact our Consumer Service department for the service center nearest to you.

- Do not immerse appliance in water.
- To reduce the risk of fire or electric shock, do not dismantle the appliance. Repair should be done by an authorized KRUPS Service Center only.

## SPECIAL CORD INSTRUCTIONS

- A. A short power-supply cord is provided to reduce the risk of becoming entangled in or tripping over a longer cord.
- B. Extension cords are available and may be used if care is exercised in their use.
- C. If an extension cord is used, (1) the marked electrical rating of the extension cord should be at least as great as the electrical rating of the appliance, (2) the cord should be arranged so that it will not drape over the counter top or table top where it can be pulled on by children or tripped over unintentionally.
- D. This appliance has a polarized plug (one blade is wider than the other). To reduce the risk of electric shock, this plug is intended to fit into a polarized outlet only one way. If the plug does not fit fully into the outlet, reverse the plug. If it still does not fit, contact a qualified electrician. Do not attempt to modify the plug in any way.

In the interest of improving products, Krups reserves the right to change specifications without prior notice.

# LIMITED WARRANTY

This Krups product is warranted for 1 year from the date of purchase against defects in material and workmanship. During this period, the Krups product that, upon inspection by Krups, is proved defective, will be repaired or replaced, at Krups' option, without charge to the customer. If a replacement product is sent, it will carry the remaining warranty of the original product. This warranty does not apply to any defect arising from a buyer's or user's misuse of the product, negligence, failure to follow Krups' instructions, use on current or voltage other than that stamped on the product, wear and tear, alteration or repair not authorized by Krups, or use for commercial purposes. THE WARRANTIES SET FORTH HEREIN ARE EXCLUSIVE AND NO OTHER WARRANTIES, EXPRESS OR IMPLIED, INCLUDING BUT NOT LIMITED TO ANY WARRANTY OF MERCHANTABILITY OR FITNESS FOR A PARTICULAR PURPOSE OR USE, ARE MADE BY KRUPS OR ARE AUTHORIZED TO BE MADE WITH RESPECT TO THE PRODUCT.

Some states do not allow limitation on how long an implied warranty lasts or do not allow the exclusion of incidental or consequential damages, so the above limitations may not apply to you. This warranty gives you specific legal rights, and you may also have other rights, which vary from state to state.

If you believe your product is defective, bring the product (or send it, postage prepaid) along with proof of purchase to the nearest authorized Krups Service Center. (Please contact your respective countries customer service department, indicated below, for the address of the nearest authorized Krups Service Center.)

If you send the product, please include a letter explaining the nature of the claimed defect.

If you have additional questions, please call our Consumer Service Department:

USA: 1-800-526-5377; Mon – Fri 8:30 a.m. – 7:00 p.m. (EST)

[www.KrupsUSA.com](http://www.KrupsUSA.com)

Canada: 1-800-418-3325; Mon – Fri 8:30 a.m. – 4:30 p.m. (EST)

[www.Krups.ca](http://www.Krups.ca)

Please note hours are subject to change.

Before calling the Consumer Service Department, please have the type number of your KRUPS appliance available. You must have this information before calling our Consumer Service Department so that we may better answer your questions. The type number can be located by looking at the bottom of your appliance.

Any general correspondence can be addressed to:

USA: KRUPS – 196 Boston Avenue – Medford MA 02155

Only letters can be accepted at this address. Shipments and packages that do not have a return authorization number will be refused.

Canada: Groupe SEB Canada Inc. – 455 Finchdene Square  
Scarborough, Ontario M1X 1B7

Thank you for choosing an appliance from the **KRUPS** Electrical Cooking assortment, designed for domestic use only.

### Description

- a** Non-stick grill or flat plates (according to model)
- b** Insulated Cool-touch handle
- c** Safety locking latch for storage
- d** On/Off indicator light
- e** Ready indicator light
- f** Floating Hinge System

### Getting Started

- Place the appliance on a stable, heat resistant surface: do not use it on a soft surface such as a table pad.

**Do not place the appliance on or near slippery or hot surfaces. Do not let the cord hang down over a source of heat (hot plates, gas cookers, etc.).**

Before using the appliance for the first time:

- Open the appliance.
- Remove any packaging, stickers and accessories from both inside and outside the appliance.
- Lightly coat the plates with vegetable oil or non-stick cooking spray.

### Using the appliance

- Close the appliance.

**Check that your electrical installation is compatible with the power and voltage shown underneath the appliance.**

**Plug the appliance into an earthed socket only.**

**If the power supply cord is damaged, it must be replaced by the manufacturer or its service agent or a similarly qualified person in order to avoid a hazard.**

- Plug into outlet. Both of the indicator lights (d) and (e) will illuminate **(1)**.
- When the appliance reaches the required temperature, the ready indicator light (e) will go out **(2)**.

*When the appliance is used for the first time, it may give off a slight odor and smoke, this is normal.*

- Open the appliance and place the food on the lower plate.
- Close the appliance. The Krups floating hinge system (f) easily adjusts to accommodate different food thickness **(3)**.
- Leave the food to cook for the desired time.
- You can open the appliance at any time to check on the progress of the cooking.
- When the desired result is achieved, remove the food using a wooden to avoid damaging the non-stick coating **(4) (5)**.
- Unplug the appliance and allow it to cool.

### Practical hints

- It is recommended to adapt cooking according to your own taste.
- Avoid the use of metallic or sharp utensils, as they will damage the non-stick coating of the plates.

### Cleaning

- Always disconnect the appliance before cleaning, and leave to cool.
- Do not place the appliance in water or under running water.
- **To clean the exterior**, wipe with a damp cloth and dry.
- **To clean the interior**, wipe the plates with a damp cloth, some dishwashing soap may be used. Then wipe with a wet sponge and dry carefully.
- **Do not use metal scouring pads, scouring powders, or abrasives** when cleaning the interior or exterior of this appliance.

### Storage

The appliance can be stored vertically to save space. Close the safety locking latch (c) for a convenient upright storage **(6)**.