

# Cuisinart®

## INSTRUCTION/ RECIPE BOOKLET



**Smart Stick® Hand Blender**

**CSB-76 SERIES**

For your safety and continued enjoyment of this product,  
always read the instruction book carefully before using.

---

# IMPORTANT SAFEGUARDS

When using an electrical appliance, basic safety precautions should always be followed including the following:

## **1. READ ALL INSTRUCTIONS.**

2. To protect against electrical shock, do not put the motor body, cord or electrical plug of this hand blender in water or other liquid. The detachable blending shaft of this appliance has been designed for immersion into water or other liquids. Never submerge any other portion of this unit. If hand blender falls into liquid, unplug the unit first, then remove blender immediately. Do not reach into the liquid without unplugging the unit first.
3. This appliance should not be used by children. To avoid possible accidental injury, close supervision is necessary when any appliance is used by or near children.
4. Unplug from outlet when not in use, before putting on or taking off parts, and before cleaning. To unplug, grasp plug and pull from electrical outlet. Never pull cord.
5. Avoid contacting moving parts.
6. During operation keep hands, hair, clothing, as well as spatulas and other utensils away from attachments and any mixing container, to reduce risk of injury to persons, and/or damage to the appliance. A spatula may be used, but must be used only when the unit is not operating.
7. Do not operate any appliance with a damaged cord or plug, or after the appliance has malfunctioned or has been dropped or damaged in any way or is not operating properly. Return the appliance to the nearest Cuisinart Repair Center for examination, repair, or mechanical or electrical adjustment.
8. Remove detachable shaft from the blender before washing the blades or shaft.
9. **Blades are SHARP. Handle carefully when removing, inserting or cleaning the blending shaft.**
10. When mixing liquids, especially hot liquids, use a tall container or make small quantities at a time to reduce spillage, splattering and possibility of injury from burning.
11. The use of attachments or accessories not recommended by Cuisinart may cause fire, electrical shock, or risk of injury.
12. Do not use outdoors, or use for other than intended use.
13. Do not let any cord hang over the edge of the table or counter. Do not let cord contact hot surfaces, including stovetop.

- 
14. Make sure the appliance is off, the motor has stopped completely, and the appliance is unplugged from outlet before putting on or taking off attachments, and before cleaning.
  15. To reduce the risk of fire or electrical shock, do not operate any heating appliance beneath the mounting unit.
  16. Maximum rating of 200w is based on the chopper/grinder attachment that draws the greatest power.
  17. To reduce the risk of injury, never place cutting blade on base without first putting bowl properly in place.
  18. Be certain cover is securely locked in place before operating appliance.

# SAVE THESE INSTRUCTIONS FOR HOUSEHOLD USE ONLY

## NOTICE

This appliance has a polarized plug (one blade is wider than the other). As a safety feature, this plug will fit in a polarized outlet only one way. If the plug does not fit fully in the outlet, reverse the plug. If it still does not fit, contact a qualified electrician. Do not attempt to defeat this safety feature.

## CONTENTS

Important Safeguards . . . . .	2
Introduction . . . . .	3
Unpacking Instructions . . . . .	4
Features and Benefits . . . . .	4
Tips and Hints . . . . .	4
Diagram . . . . .	6
Assembly . . . . .	6
Operation . . . . .	7
Cleaning . . . . .	7
Recipes. . . . .	8
Warranty . . . . .	24

## INTRODUCTION

You'll find blending easier than ever with this Smart Stick® hand blender. Pick it up to blend cold drinks, hot soups, and crêpe batter – right in the pitcher, pot or bowl. It's comfortable to hold, easy to use, and the blending shaft and beaker are dishwasher safe. Enjoy!

---

## UNPACKING INSTRUCTIONS

Place the package containing the Cuisinart® Smart Stick® Hand Blender on a sturdy surface. Unpack the Smart Stick® Hand Blender from its box by removing the upper protective insert. Gently slide the unit from the box. Remove all support materials from the box and replace the upper insert. Save packaging for possible repacking of the unit.

**Note: The blending blade is extremely sharp. Use caution when removing.**

Before using the Cuisinart® Smart Stick® Hand Blender for the first time, we recommend that you wipe the unit with a clean, damp cloth to remove any dirt or dust. Dry it thoroughly with a soft absorbent cloth. Handle carefully. Never submerge motor body housing in water or any other liquid; wash mixing container and detachable shaft by hand or in the dishwasher. Dry thoroughly before use. Read all instructions completely for detailed operating procedures.

## FEATURES AND BENEFITS

- 1. One Touch On/Off Button:** Allows you to activate the hand blender at the touch of a button. Simply press and hold down on the toggle switch to blend or pulse. Once the button is released, blending will stop.
- 2. Comfort Handle:** The handle allows you to control the hand blender with ease.
- 3. Motor Body Housing**
- 4. Detachable Shaft:** By pressing the release button on the back of the unit, the shaft will detach for easy cleaning.
- 5. Blending Attachment with Stainless Steel Blade and Blade Guard:** This attachment easily snaps into the motor body housing. The stainless blade is partially covered by a stainless housing that keeps splashing to a minimum.
- 6. Mixing Beaker:** 2-cup mixing beaker is microwave- and dishwasher-safe. Use this container to blend drinks, shakes, salad dressings and more. Designed for easy gripping and drip-free pouring.

## TIPS AND HINTS

1. Liquid should come within an inch of where the shaft attaches to the motor housing.
2. When using with a nonstick cooking surface, be careful not to scratch the coating with the hand blender.
3. Do not immerse motor body housing, in water or any other liquid.
4. Cut most solid foods into ½" cubes for easy blending.

- 
5. Pour liquid ingredients into the mixing container first, unless recipe instructs otherwise.
  6. To avoid splashing, don't turn the hand blender on until the blade is beneath the surface of the mixture, and do not pull the hand blender out of the mixture while blender is running.
  7. Do not let hand blender stand in a hot pot on stove while not in use.
  8. Do not put fruit pits, bones, or other hard material into the blending mixture, as these are liable to damage the blades.
  9. Do not fill mixing containers too full. The level of mixture will rise when blending, and can overflow.
  10. Adding liquids that are warm, not cold, facilitates blending solids with liquids.
  11. For recipes calling for ice, use crushed ice (not whole cubes) for best results.
  12. Using a gentle up-and-down motion is the best way to blend and incorporate ingredients uniformly.
  13. To avoid spatter, turn the hand blender off and let the blade stop completely before lifting the unit out of the mixture you are processing.
  14. To whip air into a mixture, always hold the blade just under the surface.
  15. To make a soup creamy in texture, use the hand blender to purée the soup solids to the desired consistency using a gentle up-and-down motion right in the saucepan. You can quickly change your soup into a thick and creamy blend.
  16. When making compound butters, remove the butter from the refrigerator and let it come to room temperature before blending in the ingredients.
  17. The hand blender is perfect for frothing milk for cappuccino or lattes.
  18. Use the hand blender to make smooth gravies and pan sauces.
  19. For best results when using celery in a recipe, use a vegetable peeler to remove tough outer strings from the celery before slicing.

---

## PARTS

1. Comfort Handle
2. Cord
3. On/Off Button
4. Motor Body Housing
5. Detachable Blending Shaft
6. Blade Guard
7. Stainless Steel Blending Blade (not shown)
8. Mixing Beaker

## ASSEMBLY

Align the motor body with the blending shaft and slide the pieces together until you hear and feel the pieces click together. It may be helpful to press the release button when assembling.

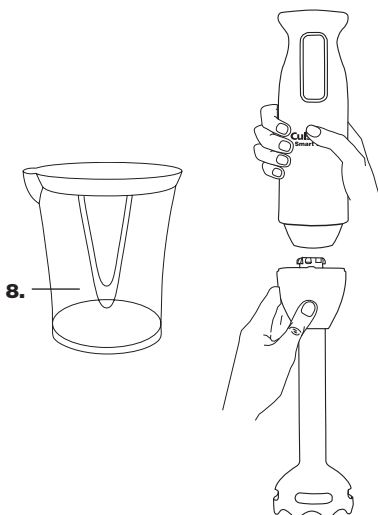
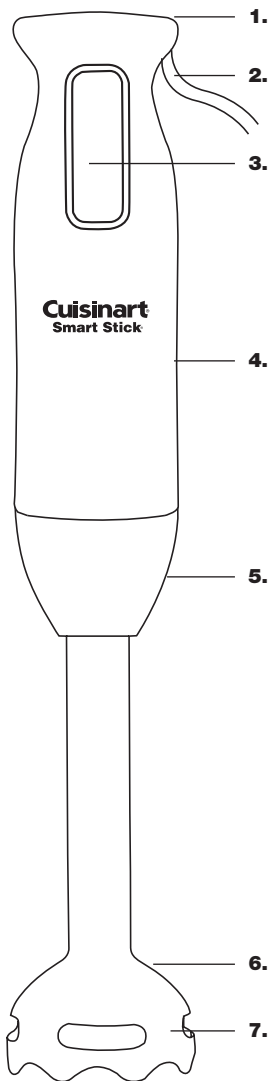

---

## OPERATION

The specially designed blade is for mixing and stirring all kinds of foods, including salad dressings, powdered drink products, and sauces. It is ideal for combining dry ingredients, and can be used to emulsify mayonnaise, too.

This blade mixes and stirs while adding only a minimum of air to your mixture. A gentle up-and-down motion is all you need to make the most flavorful, full-bodied liquid recipes. Be careful never to remove the Cuisinart® Smart Stick® Hand Blender from the liquid while in operation.

1. Insert the blending attachment into the motor body. (See Assembly, page 6.)
2. Plug electrical cord into an electrical wall socket.
3. Place blending shaft into mixture that will be blended.
4. Press and hold the ON/OFF button. The hand blender will continue to run as long as the switch is pressed in. To turn hand blender OFF, release the ON/OFF button and the motor will stop.
5. Do not hold the button ON for longer than 50 seconds at a time.
6. Unplug immediately after use.

## CLEANING

Always clean the Smart Stick® motor body and blending shaft thoroughly after using.

Remove the blending shaft from the motor body. Clean the motor body only with a sponge or damp cloth. Do not use abrasive cleaners which could scratch the surface. To clean the blending shaft, wash by hand in hot water using mild detergent, or in dishwasher.

### **Never immerse the motor body in water.**

When the appliance has malfunctioned or has been dropped or damaged in any way or it is not operating properly, return the appliance to the nearest Cuisinart Repair Center for examination, repair or mechanical or electrical adjustment.

---

# WARRANTY

## Limited Three-Year Warranty

This warranty is available to consumers only. You are a consumer if you own a Cuisinart® Smart Stick® Hand Blender that was purchased at retail for personal, family or household use. Except as otherwise required under applicable law, this warranty is not available to retailers or other commercial purchaser or owners.

We warrant that your Cuisinart® Smart Stick® Hand Blender will be free of defects in materials and workmanship under normal home use for 3 years from the date of original purchase.

We suggest you complete and return the enclosed product registration card promptly to facilitate verification of the date of original purchase. However, return of the product registration card does not eliminate the need for the consumer to maintain the original proof of purchase in order to obtain the warranty benefits. In the event that you do not have proof of purchase date, the purchase date for purposes of this warranty will be the date of manufacture.

If your Cuisinart® Smart Stick® Hand Blender should prove to be defective within the warranty period, we will repair it, or if we think necessary, replace it. To obtain warranty service, simply call our toll-free number 1-800-726-0190 for additional information from our Customer Service Representatives or send the defective product to Customer Service at Cuisinart, 150 Milford Road, East Windsor, NJ 08520.

To facilitate the speed and accuracy of your return, please enclose \$10.00 for shipping and handling of the product.

Please pay by check or money order (California residents need only supply proof of purchase and should call 1-800-726-0190 for shipping instructions).

**NOTE:** For added protection and secure handling of any Cuisinart® product that is being returned, we recommend you use a traceable, insured delivery service. Cuisinart cannot be held responsible for in-transit damage or for packages that are not delivered to us. Lost and/or damaged products are not covered under warranty.

Please be sure to include your return address, daytime phone number, description of the product defect, product model # (located on bottom of product), original date of purchase, and any other information pertinent to the product's return.

Your Cuisinart® Smart Stick® Hand Blender has been manufactured to the strictest specifications and has been designed for use with the authorized accessories and replacement parts.

This warranty expressly excludes any defects or damages caused by accessories, replacement parts, or repair service other than those that have been authorized by Cuisinart.

---

This warranty does not cover any damage caused by accident, misuse, shipment or other ordinary household use.

This warranty excludes all incidental or consequential damages. Some states do not allow the exclusion or limitation of these damages, so they may not apply to you.

### **CALIFORNIA RESIDENTS ONLY**

California law provides that for In-Warranty Service, California residents have the option of returning a nonconforming product

(A) to the store where it was purchased or

(B) to another retail store which sells Cuisinart products of the same type.

The retail store shall then, at its discretion, either repair the product, refer the consumer to an independent repair facility, replace the product, or refund the purchase price less the amount directly attributable to the consumer's prior usage of the product.

If either of the above two options does not result in the appropriate relief to the consumer, the consumer may then take the product to an independent repair facility if service or repair can be economically accomplished. Cuisinart and not the consumer will be responsible for the reasonable cost of such service, repair, replacement, or refund for nonconforming products under warranty.

California residents may also, according to their preference, return nonconforming products directly to Cuisinart for repair, or if necessary, replacement, by calling our Consumer Service Center toll-free at 1-800-726-0190.

Cuisinart will be responsible for the cost of the repair, replacement, and shipping and handling for such products under warranty.